

Building Sketch

Borrower			
Property Address			
City	County	State	Zip Code
Lender/Client			

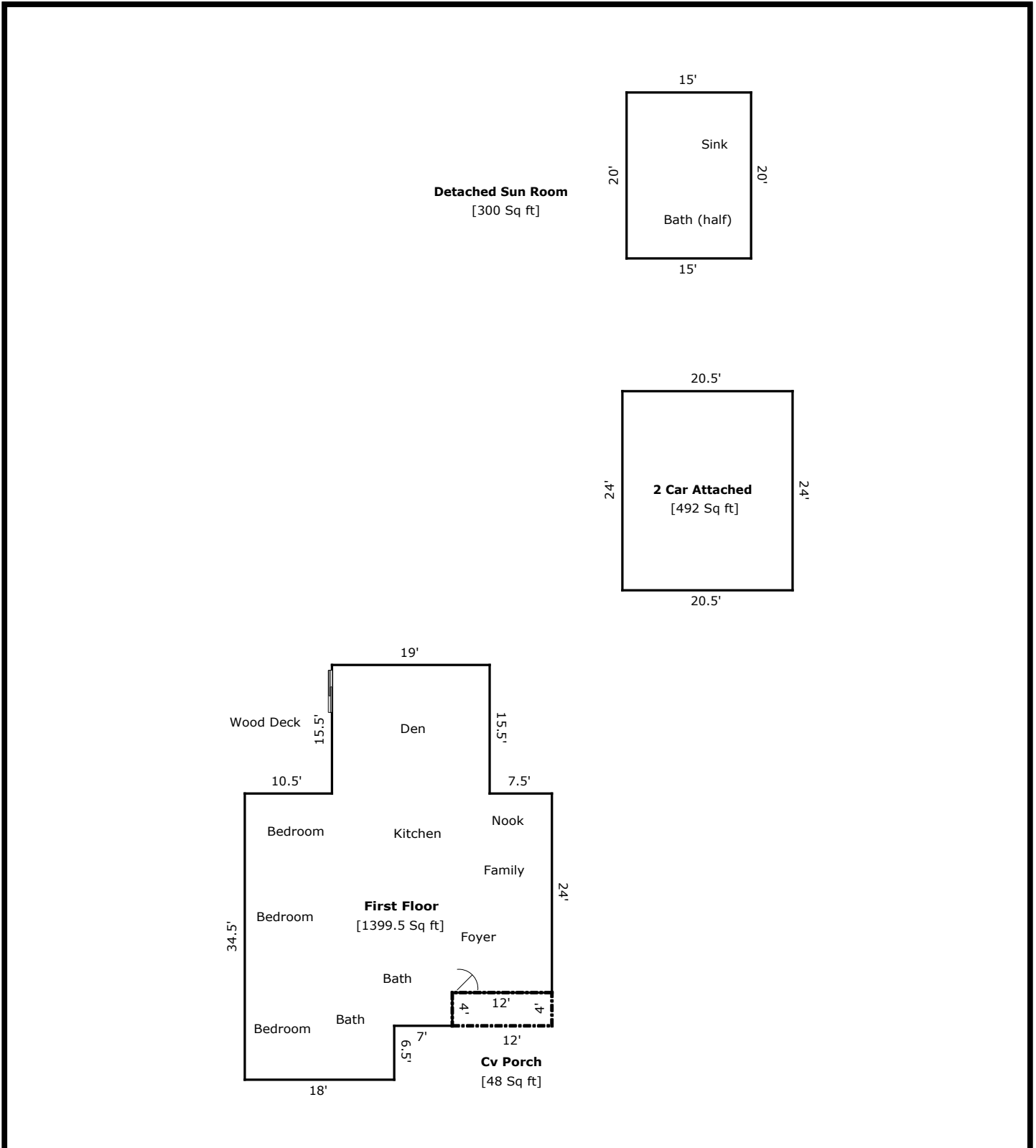

TOTAL Sketch by a la mode, inc.

Area Calculations Summary

Living Area	Calculation Details	
First Floor	1399.5 Sq ft	$19 \times 15.5 = 294.5$ $37 \times 24 = 888$ $10.5 \times 18 = 189$ $4 \times 7 = 28$
Total Living Area (Rounded):	1400 Sq ft	
Non-living Area		
Cv Porch	48 Sq ft	$4 \times 12 = 48$
2 Car Attached	492 Sq ft	$24 \times 20.5 = 492$
Detached Sun Room	300 Sq ft	$20 \times 15 = 300$